

To log into Minecraft Education Edition students use the **same login that they use at school to get onto our BAPS computer**

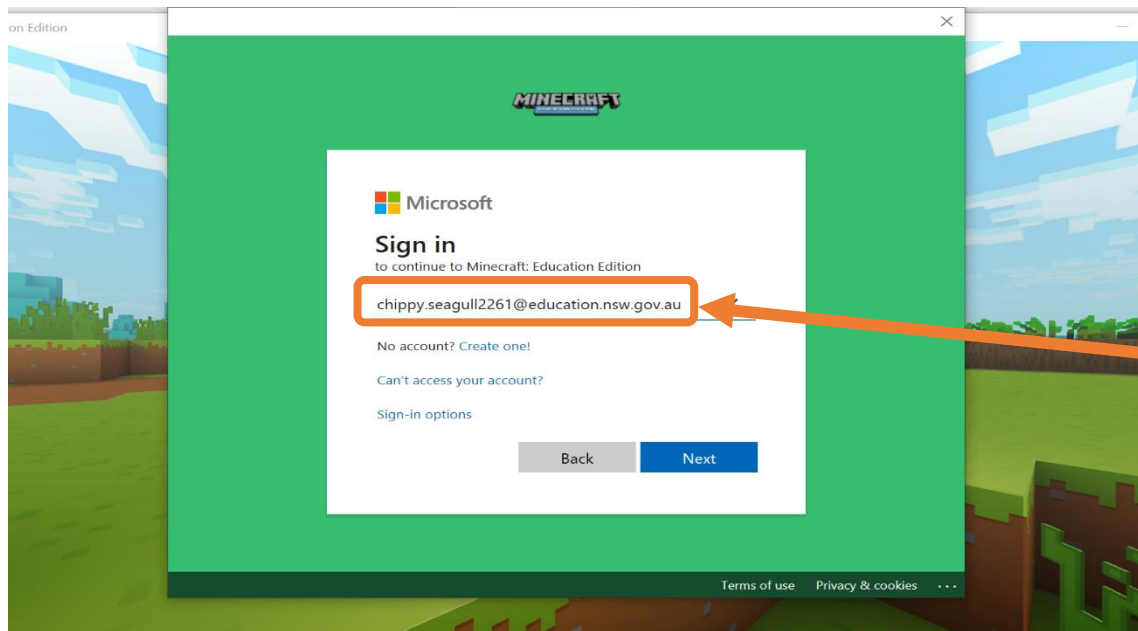

For example:

IF Chippy had a login, he would log into MEE like this:

User ID: **chippy.seagull2261**

Password: **baps**

To get passed the first screen students need to add **@education.nsw.gov.au** to their school login.

NO password is needed yet

How I log onto MEE if I had a login one



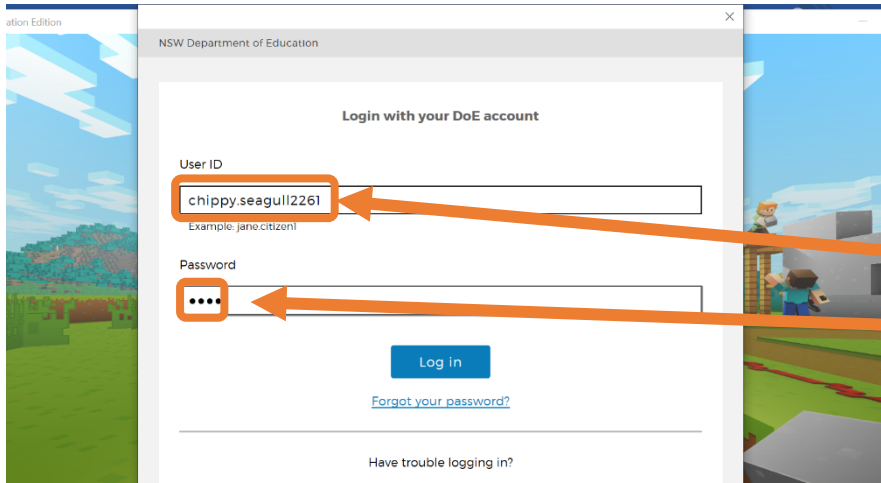

The next screen asks for students to enter their
User ID and **password**
just like they do at school

User ID: **chippy.seagull2261**

Password: **baps**



Students then can next screen to either

View the worlds they have created or

Create a new world

There are **NO JOIN WORLD** codes.
This was done at school during Library
breaks.

PLEASE don't ask BAPS for join codes.

OPTIONAL – Not tried at school

For students who are skilled at MEE maybe they could try **view library**

It opens **lessons** and **monthly build challenges**.



Here are the **lesson options**

